

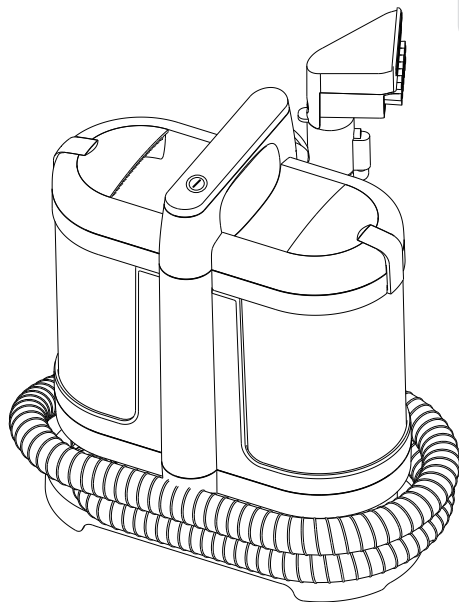

# INSTRUCTION

## Multi-Purpose Portable Cleaner

Notice .....	1
Product Description .....	2
Usage Guide .....	3
Cleaning Tips .....	7
Common Issues .....	9
Product Specifications .....	10



---

Dear users, thank you for using our Multi-Purpose Portal Cleaner.  
Please read this instruction carefully before use and retain it for future reference.

## Notice

### Notice

This product is intended for household use only. Consumers should read and follow the manufacturer's instructions carefully when using the appliance to avoid personal injury and product damage. Misuse of electrical appliances can result in severe electrical shock or fire and property damage:

1. Only for indoor use. Please do not leave the appliance unattended when it is switched on. Before using this machine, please place the machine on a flat ground.
2. Non-professionals should not disassemble the machine. When the machine is in use, please do not disassemble the machine, otherwise, it may cause harm to you.
3. Please check the power cord, hose component, and brush head component regularly, it is forbidden to use them if anywhere is damaged.
4. If the power cord is damaged, in order to avoid danger it must be repaired by professionals.
5. The water tank must be equipped with an appropriate amount of clean water before use, otherwise it may damage the machine.
6. When professionals disassemble the machine, please make sure the plug is disconnected, and the temperature of the motor and pump has dropped to normal temperature, otherwise, it will harm to people.
7. The liquid in the machine should not flow to the charging device (including the charged element), otherwise it will damage the machine.
8. Do not point the air outlet at people or animals when starting the machine or when the machine is working, otherwise, it may hurt people or animals.
9. Do not allow it to be used as a toy. Not intended for use by children aged 12 and under. Close supervision is necessary when used near children.
10. The plug must be removed from the socket-outlet before cleaning or maintaining the appliance. Turn off all controls before unplugging.
11. Use only the manufacturer's recommended attachments.
12. Do not pull or carry by cord, use the cord as a handle, close the door on the cord, pull the cord around sharp corners or edges, run the appliance over the cord, or expose the cord to heated surfaces.
13. The appliance is not to be used if it has been dropped, if there are visible signs of damage, or if it is leaking.
14. Do not pick up/ vacuum burning or glowing objects (cigarettes, matches, hot ashes). Do not use the appliance to pick up the following items: dry dust, lots of rubbish, big plastic bags, large quantities of powder, metal such as needles, and pins, and large quantities of sand and pebbles.
15. Stop working immediately when inhaling foreign objects.

## Product Description

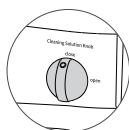
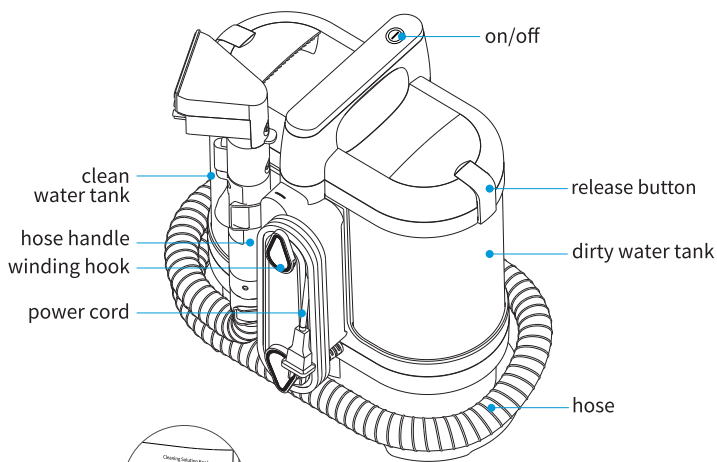

cleaning solution knob



self-cleaning joint

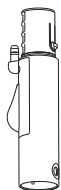

Hose handle

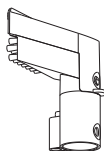

fabric brush



cleaning solution

# Usage Guide

## How to assemble

1

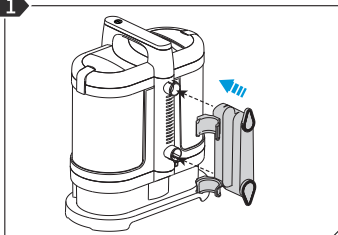

Place the rotatable winding buckle with one side facing upwards, align the two card holes, and install the winding frame at the back of the machine.

2

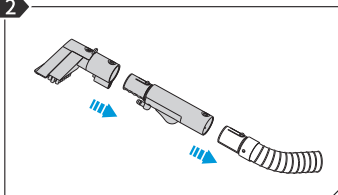

Please install the handle and fabric brush in the direction shown in the diagram.

3

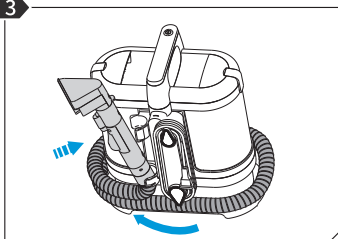

Wrap the flex hose around the machine and place the hose grip into the bracket.

4

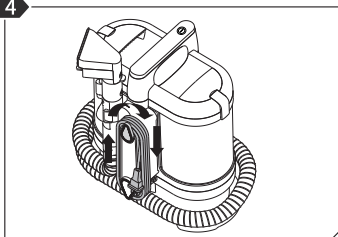

The winding rack can be used to store the power cord. When using the machine, rotate the winding buckle to release the power cord.



# Usage Guide

## Clean water tank

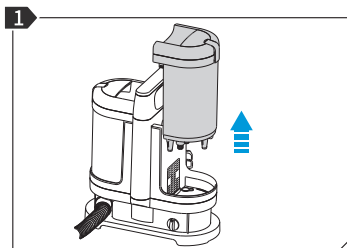

1. Place the spot cleaner on the ground, one hand presses the machine body, and the other hand holds the handle of the clean water tank cover to pull out the clean water tank.

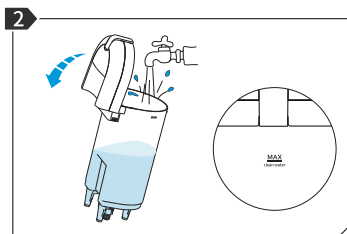

2. Press the button to open the clean water tank, the clean water in the tank should be below the MAX water line.

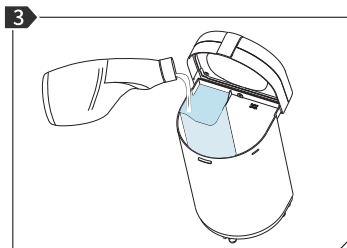

3. Open the cover of the cleaning water tank and add an appropriate amount of cleaning solution to the corresponding space. (Note that both diluted and diluted cleaning solutions have corresponding maximum lines.) It is recommended to use the specified cleaning solution.

1. If cleaning a very dirty area, use the cleaning solution directly without dilution.
2. After cleaning a less dirty area, dilute the cleaning solution with an appropriate amount of water as needed. Refer to the cleaning solution instructions for guidance.
3. If you do not need to use a cleaning solution, the cleaning solution knob at the bottom of the machine needs to rotate to close, Otherwise, it may affect the normal work of the pump.

## Usage Guide

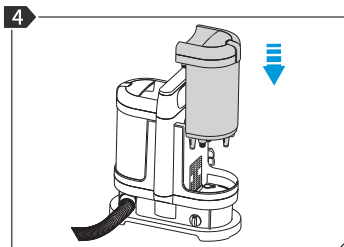

Close the lid and hear a "click", indicating that the lid is closed. Install the clean tank into the machine body.

### Start using

Before using please ensure that the clean water tank is filled with clean water and the dirty water tank is empty, both of the tanks must be installed in place. Please pay attention to whether the power cord and plug are damaged before using the machine.

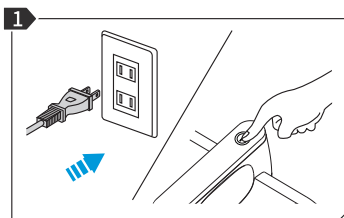

1. Pull out the hose, please check whether the brush is connected well.
2. Plugged in power then press the "switch" button, it will work.

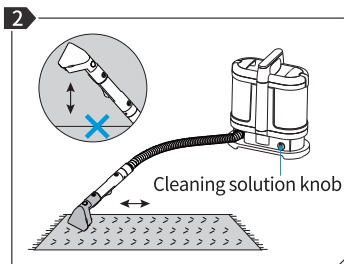

Turn the cleaning knob clockwise. Place the fabric brush in the area that needs to be cleaned.

Note: Do not lift or tilt the fabric brush when using it, please use it horizontally.

## Usage Guide

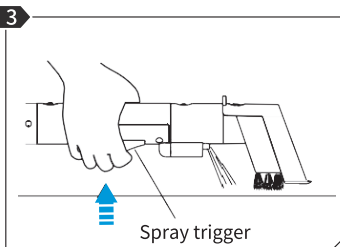

During use, press the button on the brush handle to spray the cleaning solution and the brush head should be close to the items to be cleaned. (if you find the water output from the brush head is small, release the button for a while and then press it again.)

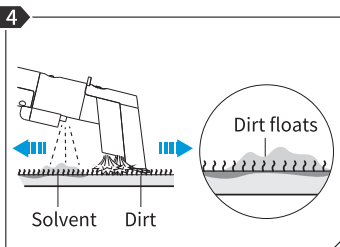

Using the brush on the tool, scrub the area to be cleaned. To lift the stain away, apply downward pressure on the tool and slowly pull it toward you. Repeat as needed.

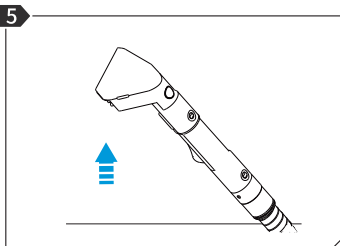

Before the end of cleaning work, release a button that controls water out and raise the brush head to facilitate dirty water to the dirty water tank.

After use, please turn off the power and clean the sewage tank promptly to avoid odors.

### Note:

1. Do not use this machine to clean expensive leather sofas to avoid damage
2. When there is no water ejecting from the brush head, the machine can not be used to absorb dust and other dry garbage.

# Cleaning Tips

## Dirty Tank Cleaning

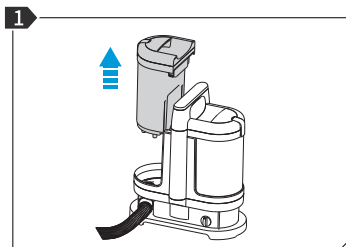

Pull up the dirty water tank from the machine.

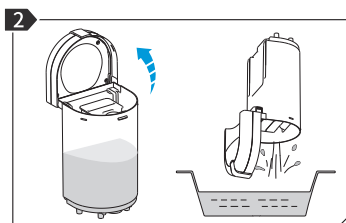

Place the tank on the table, press the button on the water tank cover, then pour out the dirty water.

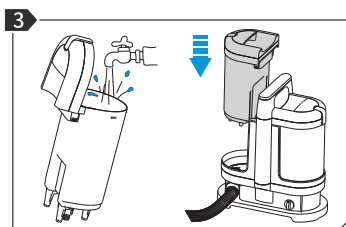

Dry the dirty tank and install it back into the machine.

### Note:

1. It is better to clear the dirty water tank after each use to avoid the bad smell. Please pay attention to whether the power cord and plug are damaged before using the machine.
2. Before cleaning or maintaining the machine, the plug should be removed from the socket, and the machine should not be immersed in water for cleaning; Please pull out the plug when not using.

## Cleaning Tips

### Hose Cleaning

1. When the user needs to clean the hose, please clean the dirty water tank and put it back into the machine.
2. Keep a proper amount of water in the clean water tank and replace the brush with a self-cleaning joint.
3. Start the machine, press and hold down the water outlet button, and the water flows back into the hose after the self-cleaning connector, keep it for 30 seconds to 1 minute, and then the hose cleaning can be completed.

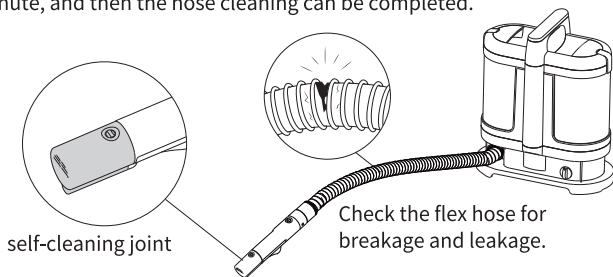

### Cleaning Accessories

Press the release button separately to remove the Stained tough brush tool and hose handle, and then clean them.

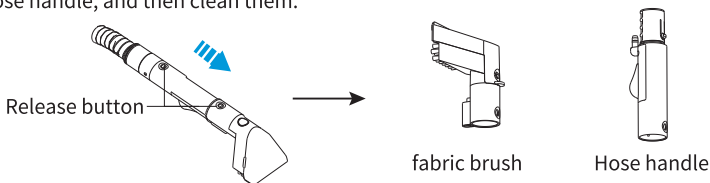

Use your hand to break open the fabric brush and apply the cover buckle to clean the fabric brush.

When cleaning the water sucker, empty the nozzle if it is blocked.

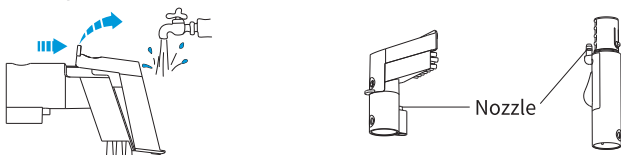

## Common Issues

issue	probable cause	try a solution
Does not work	The plug is poor contact with the socket	Make sure the plug is connect well and the machine is fully powered
The brush has no suction	The dirty water in the tank reaches the max line, the spot cleaner starts automatic protection	Clean up the dirty water tank in time after use
The noise becomes loud, and the brush cannot spray clean water	No clean water in the cleanwater tank or the cleaning solution tank is empty, and the cleaning solution knob is not closed so the air into it	Pour clean water into the clean water tank or add cleaning solution into the tank or close the clean solution knob

## Product Specifications

### Main technical parameters

Rated Voltage	AC120V ~ 60Hz	Clean Water Tank Capacity	42.27oz
Rated Power	450W	Dirty Water Tank Capacity	23.67oz

### Package Including

name	quantity	name	quantity	name	quantity
spot cleaner	1	fabric brush	1	self-clean joint	1
product instruction	1	hose handle	1	Wire winding rack	1

## WARRANTY

### Register One (1) Year Limited Warranty

This One (1) Year Limited Warranty applies to purchases made from authorized retailers of Rosewill Inc. ("Rosewill") by the original appliance owner and is not transferable. Please visit [www.rosewill.com](http://www.rosewill.com) to register your new Rosewill appliance. Failure to register your product will not diminish your warranty rights. You will be asked to provide the store name, date of purchase, model number (found on the back of your appliance) and serial number (found on the bottom of your appliance) along with your name and email address.

### Warranty Service

To obtain warranty service, please contact our Consumer Care Department by email to [techsupport@rosewill.com](mailto:techsupport@rosewill.com) or call to 1-800-575-9885. We will try to contact you as soon as possible. If we are unable to resolve the problem, you may be asked to send your appliance to the Service Department for quality inspection. Rosewill is not responsible for shipping costs related to warranty service. When returning your appliance, please include your name, mailing address, email address, phone number, and proof of the original purchase date as well as a description of the problem you are encountering with the appliance.



Explore more at *Rosewill.*

#### Technical Support Information

---

✉ [techsupport@rosewill.com](mailto:techsupport@rosewill.com) ☎ 1-800-575-9885 🌐 [www.rosewill.com](http://www.rosewill.com)

Thank you for purchasing a quality Rosewill product.

Please register your product at [www.rosewill.com](http://www.rosewill.com) for complete warranty information and support for your product.